



*Happy
Camper*

REMOTE CONTROL

*COMPATIBLE WITH ALL HAPPY CAMPER
MOVING FLAME LED CANDLES*

OVERVIEW

This slim design (3.4-inches x 1.55-inches x 0.25-inches), hand-held remote control works with any of the “Happy Camper” moving flame LED candles that are remote control capable. Turn your “Happy Camper” candles ON and OFF with this easy to use remote control. One remote can be used with all remote control enabled “Happy Camper” moving flame LED candles. This hand-held remote control provides a great way to control hard to reach candles, and it also protects the wax from handling every time you want to turn your candles ON and OFF. A long-lasting CR2025, 3.0VDC lithium button battery is included.



PREPARATIONS FOR USE

Remove the clear battery compartment insert before using the remote control. The remote is shipped with this insert installed to preserve the battery life during storage and shipment. The switch on the bottom of the “Happy Camper” moving flame LED candle must be in the ON position for the remote control to control the candle. The remote control will not control the candle if the switch on the bottom of the candle is in the TIMER or OFF position.



OPERATION

To use the remote control, point the front of the remote directly at the candle and press the ON button to turn the candle on, and press the OFF button to turn the candle off. The remote will work within a range of 15 feet or less. Make sure there are no physical obstructions (walls, glass, objects, etc.) between the remote and the candle since this may interfere with operation or reduce the range.

REPLACING THE BATTERY

The hand-held remote control requires one CR2025 lithium battery (included). To change the battery:

- Push the battery tray tab in while pulling out the tray.
- Remove the old battery, and insert a new CR2025 battery with the (+) facing up.
- Slide the tray into the remote.

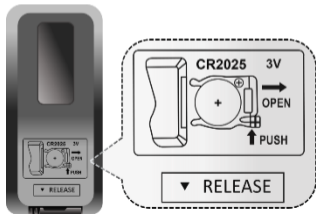

TROUBLESHOOTING

- Make sure the clear battery compartment insert has been removed.
- Make sure that the switch on the bottom of the candle is in the ON position.
- The remote cannot control the TIMER function.
- Make sure you are within the range of operation which is 15 feet or less.
- Make sure the candle is remote capable.
- The battery may be weak or dead.

BATTERY SAFETY & DISPOSAL

- Only use CR2025, 3.0VDC lithium button battery (included).
- Recycle or dispose of used battery responsibly and in accordance to federal, state and local laws.
- Insert battery into battery tray observing the correct battery polarity (+ and -).
- Failure to insert battery with the correct polarity may shorten battery life or cause the battery to leak.
- Remove battery when not in use for extended periods of time and prior to extended storage.
- Always use and replace battery under adult supervision.

BATTERY WARNINGS

KEEP OUT OF REACH OF CHILDREN.

- Swallowing may lead to serious injury or death in as little as 2 hours due to chemical burns and potential perforation of the esophagus.
- Seek immediate medical care if swallowed.
- Dispose of used batteries immediately.
- Risk of injury due to fire, explosion or leakage.
- Do not disassemble, charge, crush, or expose battery to fire or high temperature.

